

ANACO



FLAVORS™





Model 11849
18" seat height, 'A' Shell.
Shown in Persian Blue.



Model 11848
16" seat height, 'B' Shell.
Shown in Mint.



Model 11847
14" seat height, 'B' Shell.
Shown in Clementine.



Model 11846
12" seat height, 'C' Shell.
Shown in Purple.



Model 11845
10" seat height, 'C' Shell.
Shown in Red.



Flavors Stack Chair

Four-position chair allows student to sit comfortably facing front, either side or rear. Flexing seat back provides support and allows student to turn with less restriction. Flat seat pan with waterfall front edge. Five sizes. Available in 17 colors.

- The shell rests on the frame, not rivets, to add comfort.
- High-density polypropylene with color throughout the shell.
- Durable swivel-base glides with non-staining nylon bases and chrome-plated steel covers come standard
- Choose optional steel or felt glides.
- The legs are strong, 18-gauge welded steel with a durable chrome finish.

Model	Description		D"	W"	H"	F.C.	Cube	Wt.	UPS
11845	Flavors Stack Chair	C shell - 10"h	13.5	15	10	125	1.2	7	*
11846	Flavors Stack Chair	C shell - 12"h	14.5	15	12	125	1.2	7	*
11847	Flavors Stack Chair	B shell - 14"h	17	17.5	14	125	2.0	9	*
11848	Flavors Stack Chair	B shell - 16"h	18	17.5	16	125	2.0	9	*
11849	Flavors Stack Chair	A shell - 18"h	20.5	19.5	18	125	2.7	10	*

S Steel glide option for stacking chairs Set of 4 installed

F Felt glide option for stacking chairs Set of 4 installed

Glide Options

Nylon base is standard. Optional are steel base and felt base:

*This is factory installed option not available for field installation. Glide option must be on original chair order.

Steel glide option: Add 'S' to follow Model No.

Felt glide option: Add 'F' to follow Model No.

Dimension Chart							
Model	A	B	C	D	E	F	G
11845	20"	12"	13.5"	12"	15"	10"	13.75"
11846	22"	12"	14.5"	12"	15"	12"	13.75"
11847	26"	14.5"	17"	14.5"	17.5"	14"	11"
11848	29"	14.5"	18"	14.5"	18"	16"	11"
11849	31"	16"	20.5"	16"	19.5"	18"	15"

Leg Diameter
1"
1"
1"
1"

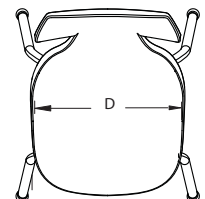
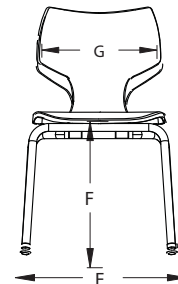
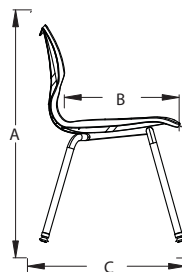



Flavors™ Chairs and Planner™ Activity Tables



Flavors Mobile Stack Chair

Four-position chair allows student to sit comfortably facing front, either side or rear. Flexing seat back provides support and allows student to turn with less restriction. Flat seat pan with waterfall front edge. Available in 17 colors.

- The shell rests on the frame, not rivets, to add comfort.
- High-density polypropylene with color throughout the shell.
- The legs are strong, 18-gauge welded steel with a durable chrome finish.

Model	Description	D"	W"	H"	F.C.	Cube	Wt.	UPS
11855	Flavors Mobile Chair A shell - 18"h	22	20	18	125	2.4	12	*



Optional Wire Bookrack

Durable chrome plating.

Model	Description	D"	W"	H"	F.C.	Cube	Wt.	UPS
17231	Wire Bookrack for 18"h Stack Chair	18	14		70		2	*
17233	Wire Bookrack for 16"h Stack Chair	18	14		70		2	*

Flavors Chair Shell Color Choice





Model 11856
12" seat height, 'C' Shell.
Shown in Apple.

Model 11857
14" seat height, 'B' Shell.
Shown in Mocha.

Model 11858
16" seat height, 'B' Shell.
Shown in Chocolate.

Model 11859
18" seat height, 'A' Shell.
Shown in Cerulean.



Flavors Sled Base Seating

Four-position chair allows student to sit comfortably facing front, either side or rear. Flexing seat back provides support and allows student to turn with less restriction. Flat seat pan with waterfall front edge. Four sizes. Available in 17 colors.

- The shell rests on the frame, not rivets, to add comfort.
- High-density polypropylene with color throughout the shell.
- Durable glides with non-staining nylon bases come standard, or choose optional felt glides.
- The legs are strong, 18-gauge welded steel with a durable chrome finish.

Model	Description		D"	W"	H"	F.C.	Cube	Wt.	UPS
11856	Flavors Sled Chair	C shell - 12"h	14.5	15	12	125	1.5	8	*
11857	Flavors Sled Chair	B shell - 14"h	18.8	17.3	14	125	1.9	10	*
11858	Flavors Sled Chair	B shell - 16"h	19	17.5	16	125	2.0	11	*
11859	Flavors Sled Chair	A shell - 18"h	21	19	18	125	2.4	12	*

F Felt glide option Set of 4 installed

Glide Options

Nylon base is standard. Optional is felt base:

*This is factory installed option not available for field installation. Glide option must be on original chair order.

Felt glide option: Add 'F' to follow Model No.

Dimension Chart					
Model	A	B	C	D	E
11856	12"	15"	14.5"	22"	12"
11857	14"	17.25"	18.75"	26"	14.5"
11858	16"	17.5"	19"	29"	14.5"
11859	18"	19"	21"	31"	16"

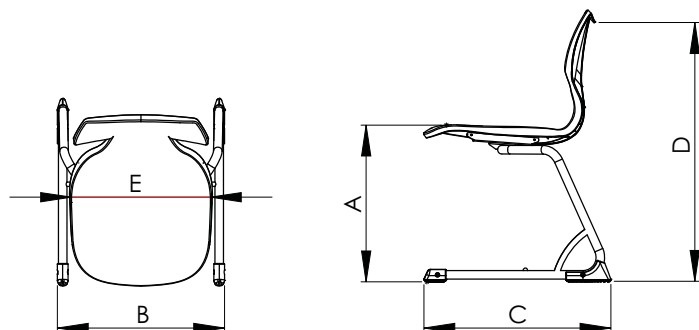



Flavors™ Stools, Acrobat™ Half Moon Desk, I-O Post™ and Cafe™ Table



Flavors Stool

Fixed-height. Four-position chair allows student to sit comfortably facing front, either side or rear. Flexing seat back provides support and allows student to turn with less restriction. Flat seat pan with waterfall front edge. Available in 17 colors.

- The shell rests on the frame, not rivets, to add comfort.
- High-density polypropylene with color throughout the shell.
- Durable swivel-base glides with non-staining nylon bases and chrome-plated steel covers come standard
- Choose optional steel or felt glides.
- The legs are strong, 18-gauge welded steel with a durable chrome finish.

Model	Description	D"	W"	H"	F.C.	Cube	Wt.	UPS
11889	Flavors Fixed-height Stool A shell - 24"h	18.5	19	24	125	2.0	12	*
11890	Flavors Fixed-height Stool A shell - 28"h	18.5	19	28	125	2.0	13	
S	Steel glide option for fixed-height stool							Set of 4 installed
F	Felt glide option for fixed-height stool							Set of 4 installed

Glide Options

Nylon base is standard. Optional are steel base and felt base:

*This is factory installed option not available for field installation. Glide option must be on original chair order.

Steel glide option: Add 'S' to follow Model No.

Felt glide option: Add 'F' to follow Model No.

Flavors Chair Shell Color Choice



FLAVORS™



Flavors P-Tablet Arm Chair
Model 11820V
Shown in Grey Mesh top with Apple edge and Apple Shell.



Flavors Rhombus Arm Chair
Model 11825V
Shown in Grey Mesh top with White edge and Apple Shell.

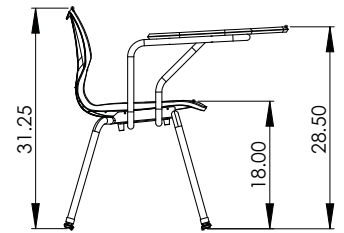
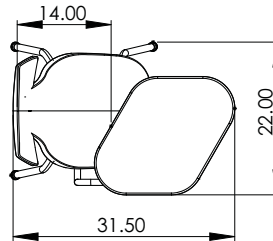
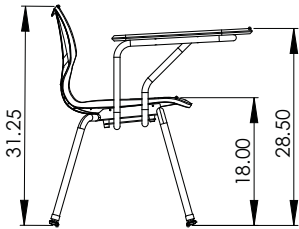
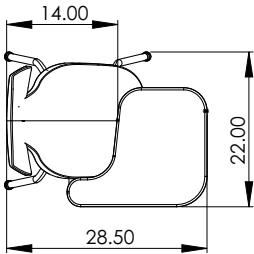

Flavors Tablet Chairs Have Top and Edge Choices



- CHOICE 5** - 3/4" top with 3mm T-Mold
G to follow Model No.
- CHOICE 6** - 3/4" top with Bullet T-Mold
V to follow Model No.

Flavors P-Tablet Arm Chair & Rhombus Arm Chair

Right or left-hand model available. Chrome frame is standard.
Top is available in 3/4" 3mm T-Mold edge or 3/4" **Bullet T-Mold edge (standard)** thickness.
Choose from 10 standard laminate colors, 20 edge colors, and 17 shell colors.

- High-pressure laminate top.
- The shell rests on the frame, not rivets, to add comfort.
- High-density polypropylene with color throughout the shell.
- Durable glides with non-staining nylon bases come standard, or choose optional steel or felt glides.
- The chrome-plated frame is strong, 18-gauge welded steel.

Model	Description	D"	W"	H"	F.C.	Cube	Wt.	UPS	
P-Tablet Arm Chair									
11820V	'A' Shell P-Tablet - Right Hand	20	17	18	125	6.3	21	*	
11821V	'A' Shell P-Tablet - Left Hand	20	17	18	125	6.3	21	*	
Rhombus Arm Chair									
11825V	'A' Shell Rhombus - Right Hand	28.5	22	31.25	125	6.3	21		
11826V	'A' Shell Rhombus - Left Hand	28.5	22	31.25	125	6.3	21		
S	Steel glide option for stacking chairs								Set of 4 installed
F	Felt glide option for stacking chairs								Set of 4 installed

Glide Options

Nylon base is standard. Optional are steel base and felt base:

*This is factory installed option not available for field installation. Glide option must be on original chair order.

Steel glide option: Add 'S' to follow Model No.

Felt glide option: Add 'F' to follow Model No.



Flavors Adjustable Chair

Flexing seat back provides support and allows student to turn with less restriction. Flat seat pan with waterfall front edge. Available in 17 colors. 5-star base in Black. 'B' Shell for elementary use and special gas lift.

- Flavors Seating adjustable chair height ranges from 16-21" for A shell; 14-18" for B shell.
- The shell rests on the frame, not rivets, to add comfort.
- High-density polypropylene with color throughout the shell.
- Available with 2" casters or glides.

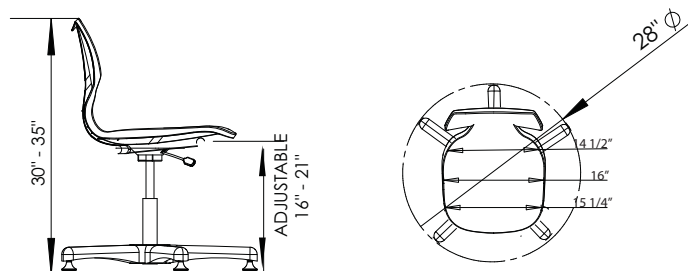

Model	Description	D"	W"	H"	F.C.	Cube	Wt.	UPS
11840	Flavors Adjustable Chair w/casters A shell	28	28	16-21	85	2.1	26	*
11841	Flavors Adjustable Chair w/glides A shell	28	28	16-21	85	2.1	26	*
11830	Flavors Adjustable Chair w/casters B shell	26	26	14-18	85	2.1	26	*
11831	Flavors Adjustable Chair w/glides B shell	26	26	14-18	85	2.1	26	*



Flavors Adjustable Stool

Flexing seat back provides support and allows student to turn with less restriction. Flat seat pan with waterfall front edge. Available in 17 colors. 5-star base in Black. Durable chrome footrest.

- Flavors Adjustable stool height ranges from 22-32".
- The shell rests on the frame, not rivets, to add comfort.
- High-density polypropylene with color throughout the shell.
- Available with 2" casters or glides.

Model	Description	D"	W"	H"	F.C.	Cube	Wt.	UPS
11842	Flavors Adjustable Stool w/casters A shell	28	28	22-32	85	2.4	34	*
11843	Flavors Adjustable Stool w/glides A shell	28	28	22-32	85	2.4	34	*

Standard Laminate Desk Top Color Choice

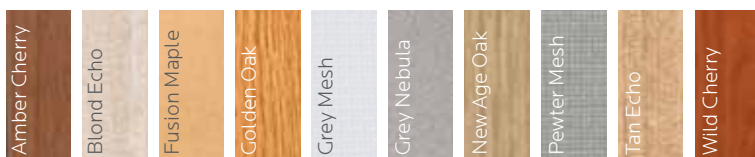

Additional Edge Only Color Choice



Frame



Flavors Chair Shell & Desk Edge Color Choice

